

DETAIL #3

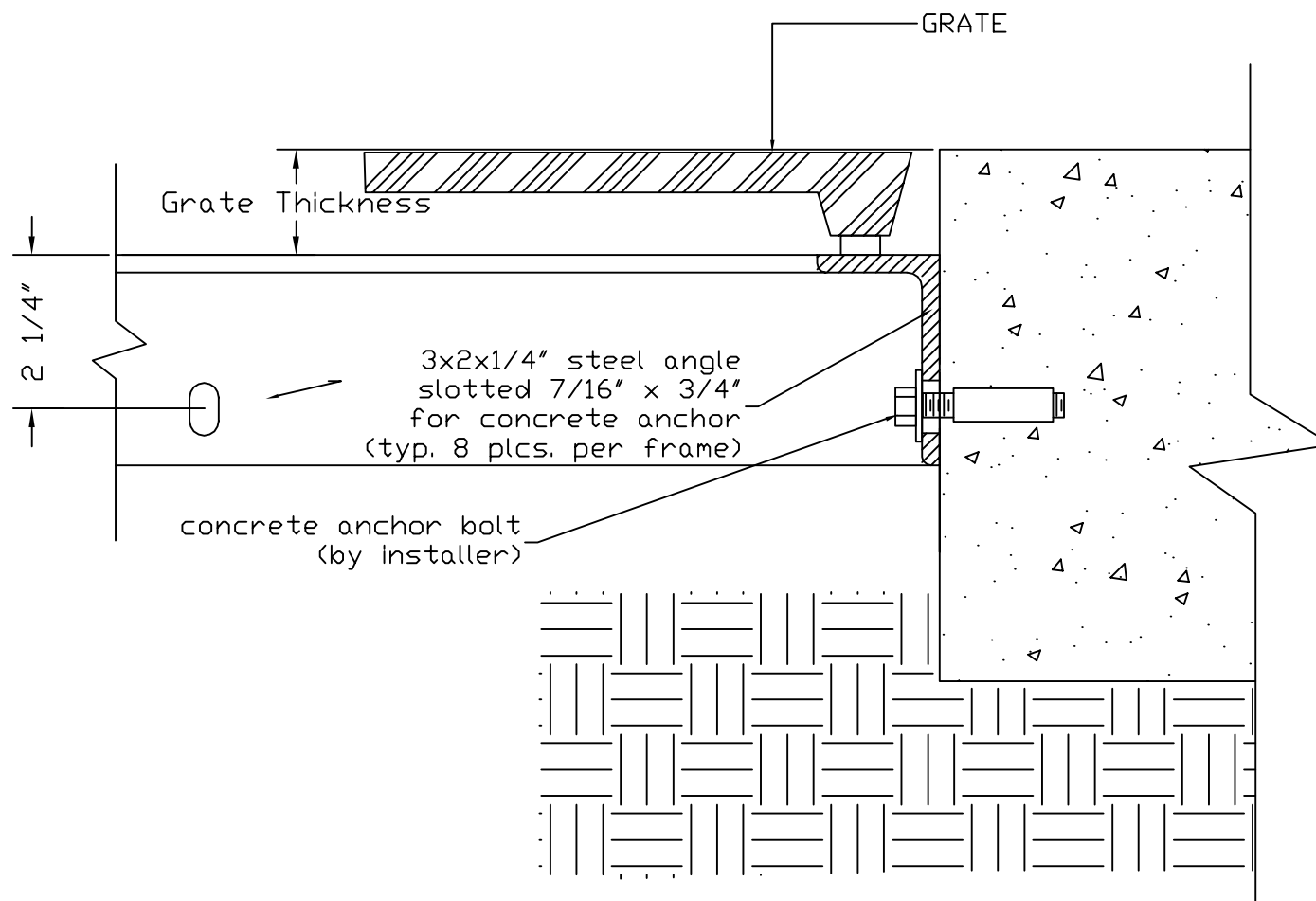

Bolt in frame for existing opening in concrete.

Anchors are to be selected and supplied by installer

Note:
This detail should only be used where existing holes are 0" to 1/2" greater than the size of the intended grate.

If openings are to be saw cut we recommend Detail #2 for more accurate installation and reduced chance of concrete edge spalling

This drawing embodies a confidential proprietary design of IRONSMITH, INC. Palm Desert, Ca. All design, manufacturing, reproduction, use, sale, and other rights regarding the same are expressly reserved. This drawing is submitted under confidential relationship for a specific purpose and the recipient agrees by accepting this drawing not to supply or disclose any information regarding it to any unauthorized person or to incorporate any special feature peculiar to this design in other projects. The information in this drawing may be covered completely or in part by patents pending.

IRONSMITH
41-701 Corporate Way #3
Palm Desert, CA 92260
(800) 338-4766
(760) 776-5080 Fax